

Vacuum and Pressure Sensors VS

Measuring range from -1 bar to 10 bar



Suitability for industry specific applications



Vacuum and Pressure Sensors VS

Application

- Electronic sensor for constant and precise measurement of vacuum and pressure values
- Conversion of vacuum and pressure values into an analog output signal for the control system
- Compact sensor unit for installation directly on the suction cup, particularly in decentralized vacuum systems
- Output of device data such as type or operating instructions via smartphone

Design

- Compact sensor unit with robust fiberglass reinforced plastic housing
- Operating mode display using LED that is visible from all sides
- M8-4 pin connection plug
- Installation via stainless steel vacuum / compressed air connection

Product highlights

- Electronic vacuum and pressure sensor with analogue switching output for precise measurements
- NFC interface allows parameterization and reading of service and maintenance data via smartphone
- Very compact and light sensors suitable for highest dynamics, installation in decentralized systems directly in the process

Designation code Vacuum and Pressure Sensors VS

VS	–	V	–	SA	–	M8-4
1		2		3		4

1 – Abbreviated designation

Code	Version
VS	VS

2 – Measuring range

Code	Measuring range in bar
V	-1 to 0
VP8	-1 to 8
P10	0 to 10

3 – Principle of function

Code	Type
SA	Sensor analog

4 – Connection electrical

Code	Connection
M8-4	Male connect M8, 4-pole

Vacuum and pressure sensor VS is delivered as a ready-to-connect product (without connection cable). The product consists of:

- Vacuum and pressure sensor of type VS - available as vacuum version, pressure version or combined version

Available accessories: connection cable, mounting bracket

Vacuum and Pressure Sensors VS

Measuring range from -1 bar to 10 bar

Ordering data Vacuum and Pressure Sensors VS

Type	Part no.
VS V SA M8-4	10.06.02.00560
VS VP8 SA M8-4	10.06.02.00562
VS P10 SA M8-4	10.06.02.00561

Ordering data Accessories Vacuum and Pressure Sensors VS

Type	Part no.
Connection cable, M8 4-pole, 3 m, PUR, straight	ASK B-M8-4 3000 K-4P 10.06.02.00472
Mounting bracket	BEF-WIN 21x22x60.5 1.5 VS 10.06.02.00061

Technical data Vacuum and Pressure Sensors VS

Type	Measuring range [bar]	Measured medium	Max. overpressure safety [bar]	Repeatability	Inputs / outputs	Electrical connection
VS V SA M8-4	-1,0 ... 0,0 bar	Non-aggressive gases; dry, oil-free air	8	± 3% of full-scale value	Analog: 0...10 V	Male connect M8, 4 pole
VS VP8 SA M8-4	-1,0 ... 8,0 bar	Non-aggressive gases; dry, oil-free air	12	± 3% of full-scale value	Analog: 0...10 V	Male connect M8, 4 pole
VS P10 SA M8-4	0,0 ... 10,0 bar	Non-aggressive gases; dry, oil-free air	15	± 3% of full-scale value	Analog: 0...10 V	Male connect M8, 4 pole

Type	Connection	Voltage	Current consumption [mA]	Protection type IP	Temperature influence	Operating temperature [°C]	Weight [g]
VS V SA M8-4	G1/8"-M + M5-F	15-30V DC	10	IP 65	± 3% of full-scale value	0 ... 50 °C	12
VS VP8 SA M8-4	G1/8"-M + M5-F	15-30V DC	10	IP 65	± 3% of full-scale value	0 ... 50 °C	12
VS P10 SA M8-4	G1/8"-M + M5-F	15-30V DC	10	IP 65	± 3% of full-scale value	0 ... 50 °C	12

Vacuum and Pressure Sensors VS

Measuring range from -1 bar to 10 bar

Design data Vacuum and Pressure Sensors VS

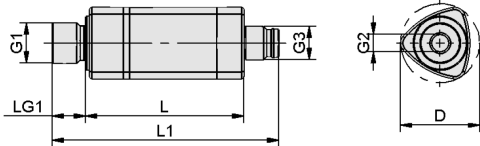

VS

Vacuum and Pressure Sensors VS

Measuring range from -1 bar to 10 bar

Design data Vacuum and Pressure Sensors VS

Type	D [mm]	G1	G2		L [mm]	L1 [mm]	LG1 [mm]
VS V SA M8-4	20	G1/8"-M	M5-F	M8x1-M	38	55	8
VS VP8 SA M8-4	20	G1/8"-M	M5-F	M8x1-M	38	55	8
VS P10 SA M8-4	20	G1/8"-M	M5-F	M8x1-M	38	55	8